



RASCO Residential

SPRINKLER PRODUCT BROCHURE

Contents

3.	Overview & Introduction	<hr/>
4.	Sprinklers	<hr/>
5.	Sprinklers	<hr/>
6.	Cover Plate Finishes	<hr/>
7.	CPVC Introduction	<hr/>
8.	Residential Riser	<hr/>
9.	CPVC Pipe & Hangers	<hr/>
10.	CPVC Couplings, Unions & Reducing Bush	<hr/>
11.	CPVC Reducing Bush Continued & Elbows	<hr/>
12.	CPVC Elbows & Tee 90°c	<hr/>
13.	CPVC Tee Reducing	<hr/>
14.	Cross 90°c, Caps & Sprinkler Tee 90°c	<hr/>
15.	Sprinkler Elbows & Adaptors	<hr/>
16.	Female & Male Adaptors	<hr/>
17.	Test Plug, Cement, Sealant & Ball Valve	<hr/>
		<hr/>

Reliable Residential Sprinklers

- All of Reliable’s residential fire sprinklers identify the K-Factor of the sprinkler in the model number of the sprinkler (i.e. F1RES 30: K-Factor = 3.0, Metric = 43)
- All of Reliable’s residential fire sprinklers have passed UL 1626 and/or UL1626A fire tests and are listed for use in installations governed by the NFPA 13D, 13R & 13 standards.
- NFPA 13D (2007) section 8.1.3.1.2 and NFPA 13R (2007) section 6.8.1.3.1.3 state, ‘Where construction features or other special conditions exist that are outside the scope of the sprinkler listings, listed sprinklers shall be permitted to be installed beyond their listing limitations.’
- Flat ceilings are defined by the NFPA standards as having a slope not exceeding 2 inches of rise for 12 inches of run.
- As residential sprinkler systems continue to evolve, The Reliable Automatic Sprinkler Co. will be offering new fire sprinklers that meet or exceed the new National Sanitary Foundation (NSF) maximum lead content requirements for use in potable water (i.e, drinking water) systems.

NFPA 13D and 13R

There is a significant difference in the approach adopted by NFPA standards in that the NFPA 13D and 13R apply to a relatively limited type and size of premises when compared with BS 9251 which covers a wider range of property type and size: NFPA 13D covers the design, installation and maintenance of automatic sprinkler systems for protection against the fire hazards in one-and two-family dwellings and manufactured homes.

NFPA 13R covers the design and installation of automatic sprinkler systems for protection against fire hazards in residential occupancies up to and including four stories in height.

These standards are predicated on the design densities utilised in UL 1626, 2.04mm/min.

The BS9251 has three categories of building with differing requirements for design density and or duration of supply (see diagram below).

Category of System	Building Type	Design Density	No. of Heads	Duration of Supply
1	Single Family Dwellings.	2.04	1 or 2	10 mins
2	Blocks of flats greater than 18m in height. Small residential care premises with ten residents or fewer. Sheltered and extra care housing.	2.80	1 or 2	30 mins
3	Residential care premises with more than ten residents Dormitories, Hostels.	2.80	2 to 4	30 mins

Sprinklers



F1 Pendent Residential Sprinklers – Bulletins 135 & 176

Sprinkler	K-Factor	Temp	Colour	Part No.
F1 RES 30	43 (3.0)	68°C	White	CV15872199
F1 RES 49	70.6 (4.9)	68°C	White	CV15872899
F1 RES 58	83.5 (5.8)	68°C	White	CV15873199
F1 RES 76	108.5 (7.6)	68°C	White	CV15113298

Recessing Escutcheon – Bulletins: 204 & 210

Size	Colour	Part No.
15mm (1/2")	White	6800840000

Note: Above Sprinklers also available in Chrome, Brass & Special Colours and 79°C



F1 Conical Concealed Pendent Residential Sprinklers – Bulletins 135 & 176

Sprinkler	K-Factor	Temp	Colour	Part No.
F1 RES 30 CCP	43 (3.0)	68°C	Brass	CM15172199
F1 RES 49 CCP	70.6 (4.9)	68°C	Brass	CM15172899
F1 RES 58 CCP	83.5 (5.8)	68°C	Brass	CM15173199
F1 RES 76 CCP	108.5 (7.6)	68°C	Brass	CM15173298



Required Cover Plate

One Size	White	MPN: 6187161318
----------	-------	-----------------



F1 Residential Side Wall Sprinklers – Bulletins 135 & 176

Sprinkler	K-Factor	Temp	Colour	Part No.
F1 RES 44	63.4 (4.4)	68°C	White	CV52872599
F1 RES 58	83.5 (5.8)	68°C	White	CV52873199

Recessing Escutcheon – Bulletins 204 & 210

Size	Colour	Part No.
15mm (1/2")	White	6800840000

Note: Above Sprinklers also available in Chrome, Brass & Special Colours and 79°C

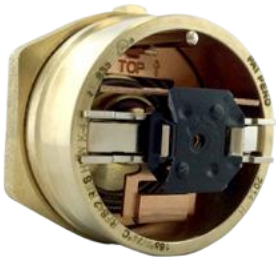

Residential Flat Concealed Horizontal Sidewall Sprinkler – RFS42 – Bulletin 048

Sprinkler	K-Factor	Temp	Colour	Part No.
RFS42	60 (4.2)	74°C	Brass	2216172499

Required Cover Plate

One Size	White	Part No: 6887231372
----------	-------	---------------------

Features:

- Coverage to 4.9m x 6.1m (16ft x 20ft)
- Flat cover plate (Solid or Perforated) for a flush, concealed wall finish.
- Sized to fit in a 89mm (3 1/2 ") or larger stud space even when installed directly in a TorqueSafe™ 90° Sprinkler Head Elbow and several other common 15mm (1/2"), 20mm x 13mm (3/4" x 1/2") or 25mm x 15mm (1" x 1/2") fittings.
- Push-on/pull-off flat cover plate.
- Sprinkler shipped complete with factory installed protective cap.



Sprinklers



F1 Residential Side Wall Concealed Sprinklers – Bulletin 135 & 176

Sprinkler	K-Factor	Temp	Colour	Part No.
F1 RES 44 SWC	63.4 (4.4)	68°C	Brass	CM52172599



Required Cover Plate – Bulletin 135

One Size	White	Part No: 6887131318
----------	-------	---------------------



F1 Residential Side Wall Sprinklers (HSWX) – Bulletin 135 & 176

Sprinkler	K-Factor	Temp	Colour	Part No.
F1 RES 58 HSWX	Bulb 83.5 (5.8)	68°C	White	CV62873199
KRES 58 HSWX	Link 83.5 (5.8)	74°C	White	MV62873199

Features:

- Low flow residential horizontal sidewall sprinkler engineered to provide a minimum design density of 0.05 gpm/ft² over the listed coverage areas
- 3mm glass bulb
- Link Version
- Recessed model utilizes a steel two piece escutcheon with a ½" adjustment (F2)
- 14' x 26' maximum coverage area

Recessing Escutcheon

Size	Colour	Part No.
15mm (½")	White	6800840000

Note: Above Sprinkler also available in Chrome, Brass and Special Colours



F1 Flat Plate Concealed Pendent Residential Sprinklers- Bulletin 006

Sprinkler	K-Factor	Temp	Colour	Part No.
RFC 30	43 (3.0)	74°C	Brass	1816172197
RFC 43	62.4 (4.3)	74°C	Brass	1816172597
RFC 49	70.6 (4.9)	74°C	Brass	1816172697
RFC 56	80 (5.6)	74°C	Brass	1816172899



Required Cover Plate – Bulletin 048

One Size	White	Part No: 6887011319
----------	-------	---------------------

Note: Above Coverplate is also available in Special Colours

Cover Plate Finishes

Reliable cover plates are available in two standard finishes



Bright Chrome



White Paint

Six special application finishes



Bright Brass



Black Plating



Black Paint



Off White



Satin Chrome



Bronze

Perforated cover plates



White



Chrome



Custom colours can also be provided.
Please allow additional time.

All custom finishes must be done by Reliable
Due to variation in printing, we cannot guarantee the colours shown here with actual products. Please check with your local Reliable sales office.

CPVC

CPVC plastic pipes and fittings have been tested and approved under Loss Prevention Standard LPS 1260.

CPVC fire sprinkler piping is manufactured from a special thermoplastic: Post-Chlorinated Polyvinyl Chloride. The characteristics of the material and the pipe dimensions provide unique advantages in sprinkler installations: superior hydraulics; ease of joining; and easy assembly with readily available, inexpensive tools.

The product has a continuous service history of more than 30 years.

Designed For Wet Systems:

CPVC fire sprinkler systems are designed for use in wet pipe systems only (a wet pipe system contains water and is connected to a water supply system so that water will discharge immediately when the sprinkler is opened). CPVC fire sprinkler systems must never be used in a system using compressed air or other gases. Note that it is not permitted to use CPVC fire sprinkler piping in areas within such occupancies where higher hazard conditions exist, such as in commercial kitchens, plant rooms or store rooms. CPVC is not suitable for applications listed as OH2, OH3, OH4, or High Hazard. It is also unsuitable for dry or pre-action systems.

CPVC fire sprinkler pipes and fittings are suitable for use in areas where the ambient temperatures are within the range 2°C to 50°C. They are not listed for outdoor use as long term exposure to UV light (sunlight) will fade the pipe surface and may result in a reduced service life (the design life of the system is 50 years). CPVC is widely resistant to corrosion and is also resistant to a large range of chemicals that are corrosive to metal piping, however care must be taken to avoid contact with chemicals that are harmful to CPVC including some that are found in some common construction products. Particular care should be taken to avoid contamination with edible oils, esters, ketones or petroleum based products such as cutting or packing boils that may be present in metallic system components, as well as traditional pipe thread pastes or dopes.

Storing CPVC and Cement:

Do not store or install CPVC products in direct contact with plasticizer containing materials such as electrical tape or certain wire and cable insulations. CPVC fire sprinkler piping can be overpainted, but only water or latex based paints should be used. Oil based paints or any type of paint with solvent content, must not be used with CPVC.

Solvent cement should be stored at temperatures between 5°C and 33°C. The cement should be stirred before use. If the cement is found to be gelled it should be discarded. The cement should be used within TWO YEARS of the date stamped on the bottom of the tin.



Residential Riser Assemblies

Residential Riser Base Unit - Bulletin 425		
Size	Part No.	
30mm (1")	6501202240	
40mm (1½")	6501202242	
50mm (2")	6501202244	



Features:

- Stainless steel body construction.
- All brass trim.
- Factory assembled.
- Factory pressure tested at 200 psi (13.8 bar).
- Choice of trim: Basic Trim, Basic Trim with Pressure Relief Valve, Basic Trim with TEST and DRAIN, Basic Trim with TEST and Pressure Relief Valve.
- Choice of mounting options: Supply/system lines support, Support bracket (to stud), Recessed or flush mount (to wood panel).
- BSPT (female x female) or NPT (female x female) connections.
- Slim design allows for easy installation within 50mm x 101mm on 406mm centres wood frame construction.
- Dedicated UL Listed water flow detector assures optimum sensitivity.

Flow Switch

Potter VSR-SFG – Solvent Cement Spigot			
Size	Part No.		
One Size	6990006055		



Features:

- The Model VSR-SG is a vane type waterflow switch for use on wet sprinkler systems using CPVC plastic fittings that use 25mm (1"), 32mm (1 ¼"), 38mm (1 ½") or 50mm (2") pipe sizes. It is equipped with a union to accommodate installation in confined spaces.
- The VSR-SG contains two single pole, double throw, snap action switches and an adjustable instantly recycling pneumatic retard. The switches are actuated when a flow of 10 GPM (38LPM) or more occurs downstream of the switch. The flow condition must exist for a period of time necessary to overcome the selected retard period.
- UL, CUL and CSFM Listed, CE Marked

Service Pressure: Up to 175PSI (12,07 BAR)

Flow Sensitivity Range for Signal: 4-10 GPM (15-38 LPM) – UL

T-TAP (WFDTN) Series Waterflow Detector			
Size	Part No.		
One Size	6990017635		



The T-Tap Series Waterflow Detector is designed for residential and branch-line signaling; NEMA 4 Rating.

1" NPT branch, including 1", 1 ¼", 1 ½", and 2".

NPT threaded ferrous and brass tees; 1", 1 ¼", 1 ½", and 2" copper sweat tees; Tyco, Spears, NIBBCO brand 1" CPVC tees.

Service Use:	
British Standard	BS9251
Automatic Sprinkler	NFPA-13
One or Two family dwelling	NFPA-13D
Residential occupancy up to four stories	NFPA-13R
National Fire Alarm Code	NFPA-72

Pipe

3.05 Metre (10 foot) Length



Size (Inch)	Size (mm)	Spears PN	Reliable PN		
¾	20	CP-007	7195030010		
1	25	CP-010	7195040010		
1 ¼	32	CP-012	7195050010		
1 ½	40	CP-015	7195060010		
2	50	CP-020	7195080010		
2 ½	65	CP-025	7195100010		
3	80	CP-030	7195120010		

Hangers

Single Fastener – Strap Hanger



Size (Inch)	Size (mm)	Spears PN	Reliable PN		
¾	20	22-007	7M99001900		
1	25	22-010	7M99001901		
1 ¼	32	22-012	7M99001902		
1 ½	40	22-015	7M99001903		
2	50	22-020	7M99001904		

Double Fastener – Strap Hanger



Size (Inch)	Size (mm)	Spears PN	Reliable PN		
¾	20	23-007	7M99001905		
1	25	23-010	7M99001906		
1 ¼	32	23-012	7M99001907		
1 ½	40	23-015	7M99001908		
2	50	23-020	7M99001909		

Side Mount– Side Hanger



Size (Inch)	Size (mm)	Spears PN	Reliable PN		
¾	20	24-007	7M99001910		
1	25	24-010	7M99001911		
1 ¼	32	24-012	7M99001912		
1 ½	40	24-015	7M99001913		
2	50	24-020	7M99001914		

Stand off



Size (Inch)	Size (mm)	Spears PN	Reliable PN		
¾	20	514-000	7M99001915		
1	25	514-010	7M99001916		
1 ¼	32	514-012	7M99001917		
1 ½	40	514-015	7M99001918		
2	50	514-020	7M99001919		

Pipe

3.05 Metre (10 foot) Length



Size (Inch)	Size (mm)	Spears PN	Reliable PN		
¾	20	CP-007	7195030010		
1	25	CP-010	7195040010		
1 ¼	32	CP-012	7195050010		
1 ½	40	CP-015	7195060010		
2	50	CP-020	7195080010		
2 ½	65	CP-025	7195100010		
3	80	CP-030	7195120010		

Hangers

Single Fastener – Strap Hanger



Size (Inch)	Size (mm)	Spears PN	Reliable PN		
¾	20	22-007	7M99001900		
1	25	22-010	7M99001901		
1 ¼	32	22-012	7M99001902		
1 ½	40	22-015	7M99001903		
2	50	22-020	7M99001904		

Double Fastener – Strap Hanger



Size (Inch)	Size (mm)	Spears PN	Reliable PN		
¾	20	23-007	7M99001905		
1	25	23-010	7M99001906		
1 ¼	32	23-012	7M99001907		
1 ½	40	23-015	7M99001908		
2	50	23-020	7M99001909		

Side Mount– Side Hanger



Size (Inch)	Size (mm)	Spears PN	Reliable PN		
¾	20	24-007	7M99001910		
1	25	24-010	7M99001911		
1 ¼	32	24-012	7M99001912		
1 ½	40	24-015	7M99001913		
2	50	24-020	7M99001914		

Stand off



Size (Inch)	Size (mm)	Spears PN	Reliable PN		
¾	20	514-000	7M99001915		
1	25	514-010	7M99001916		
1 ¼	32	514-012	7M99001917		
1 ½	40	514-015	7M99001918		
2	50	514-020	7M99001919		

Reducing Bush Continued

Reducing Bush					
Size (Inch)	Size (mm)	Spears PN	Reliable PN		
1 ½ x 1 ¼	40 x 32	4237-212	7125060500		
2 x ¾	50 x 20	4237-248	7125080300		
2 x 1	50 x 25	4237-249	7125080400		
2 x 1 ¼	50 x 32	4237-250	7125080500		
2 x 1 ½	50 x 40	4237-251	7125080600		
2 ½ x 1 ¼	65 x 32	4237-290	7125100500		
2 ½ x 1 ½	65 x 40	4237-291	7125100600		
2 ½ x 2	65 x 50	4237-292	7125100800		
3 x 2	76 x 50	4237-338	7125120800		
3 x 2 ½	76 x 65	4237-339	7125121000		



Reducing Bush- Spigot x Metal Female Thread					
Size (Inch)	Size (mm)	Spears PN	Reliable PN		
1 x ½	25 x 13	4238-130BR	6990003821		

Elbows

90° Elbow					
Size (Inch)	Size (mm)	Spears PN	Reliable PN		
¾	20	4206-007	7107030300		
1	25	4206-010	7107040400		
1 ¼	32	4206-012	7107050500		
1 ½	40	4206-015	7107060600		
2	50	4206-020	7107080800		
2 ½	65	4206-025	7107101000		
3	76	4206-131	7107121200		



90° Elbow					
Size (Inch)	Size (mm)	Spears PN	Reliable PN		
1 x ¾	25 x 20	4206-131	7109040300		

45° Elbow					
Size (Inch)	Size (mm)	Spears PN	Reliable PN		
¾	20	4217-007	7103030300		
1	25	4217-010	7103040400		
1 ¼	32	4217-012	7103050500		
1 ½	40	4217-015	7103060600		
2	50	4217-030	7103080800		
2 ½	65	4217-025	7103101000		
3	76	4217-030	7103121200		



Elbows



22.5° Elbow					
Size (Inch)	Size (mm)	Spears PN	Reliable PN		
¾	20	4216-007	6990004153		
1	25	4216-010	7103040403		
1 ¼	32	4216-012	7103050503		
1 ½	40	4216-015	7103060603		
2	50	4216-020	6990002818		



Street Elbows					
Size (Inch)	Size (mm)	Spears PN	Reliable PN		
¾	20	4209-007	7110030300		
1	25	4209-010	7110040400		
1 ¼	32	4209-012	7110050500		
1 ½	40	4209-015	7110060600		
2	50	4209-020	7110080800		



45° Street Elbow					
Size (Inch)	Size (mm)	Spears PN	Reliable PN		
1	25	4227-010	7103040401		



Side Outlet Elbow					
Size (Inch)	Size (mm)	Spears PN	Reliable PN		
¾	20	4213-007	7107030303		
1	25	4231-010	7107040404		

Tee 90°



Tee Straight - Socket x Socket x Socket					
Size (Inch)	Size (mm)	Spears PN	Reliable PN		
¾	20	4201-007	7111030303		
1	25	4201-010	7111040404		
1 ¼	32	4201-012	7111050505		
1 ½	40	4201-020	7111060606		
2	50	4201-020	7111080808		
2 ½	65	4201-030	7111101010		
3	76	4201-030	7111121212		

Tee Reducing



Tee Reducing - Socket x Socket x Socket

Size (Inch) A x B x C	Size (mm)	Spears PN	Reliable PN		
¾ x ¾ x 1	20 x 20 x 25	4201-102	7117030304		
1 x ¾ x ¾	25 x 20 x 20	4201-125	7117040303		
1 x ¾ x 1	25 x 20 x 25	4201-126	7117040304		
1 x 1 x ¾	25 x 25 x 20	4201-131	7115040403		
1 ¼ x 1 x ¾	32 x 25 x 20	4201-157	7115050403		
1 ¼ x 1 x 1	32 x 25 x 25	4201-158	7117050404		
1 ¼ x 1 x 1 ¼	32 x 25 x 32	4201-159	7117060405		
1 ¼ x 1 ¼ x ¾	32 x 32 x 20	4201-167	7115050503		
1 ¼ x 1 ¼ x 1	32 x 32 x 25	4201-168	7115050504		
1 ¼ x 1 ¼ x 1 ½	32 x 32 x 40	4201-169	7117050506		
1 ½ x 1 ¼ x ¾	40 x 32 x 20	4201-201	7115060503		
1 ½ x 1 ¼ x 1	40 x 32 x 25	4201-202	7115060504		
1 ½ x 1 ½ x ¾	40 x 40 x 20	4201-210	7115060603		
1 ½ x 1 ½ x 1	40 x 40 x 25	4201-211	7115060604		
1 ½ x 1 ½ x 1 ¼	40 x 40 x 32	4201-212	7115060605		
2 x 2 x ¾	50 x 50 x 20	4201-248	7115080803		
2 x 2 x 1	50 x 50 x 25	4201-249	7115080804		
2 x 2 x 1 ¼	50 x 50 x 32	4201-250	7115080805		
2 x 2 x 1 ½	50 x 50 x 40	4201-251	7115080806		
2 ½ x 2 ½ x 1	65 x 65 x 25	4201-289	7115101004		
2 ½ x 2 ½ x 1 ¼	65 x 65 x 32	4201-290	7115101005		
2 ½ x 2 ½ x 1 ½	65 x 65 x 40	4201-291	7115101006		
3 x 3 x 2	76 x 76 x 50	4201-338	7115121208		
3 x 3 x 2 ½	76 x 76 x 65	4201-339	7115121210		

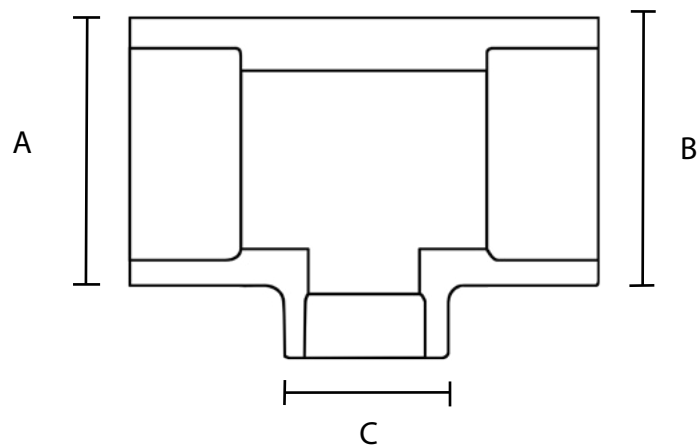

Cross 90°



Cross					
Size (Inch)	Size (mm)	Spears PN	Reliable PN		
¾	20	4220-007	7171030000		
1	25	4220-010	7171040000		
1 ¼	32	4220-012	7171050000		
1 ½	40	4220-015	7171060000		
2	50	4220-020	7171080000		
2 ½	65	4220-025	7171100000		
3	76	4220-030	7171120000		

Cross Reducing

Size (Inch)	Size (mm)	Spears PN	Reliable PN		
1 x ¾	25 x 20	4220-131	7173040403		
1 ¼ x ¾	32 x 20	4220-167	7173050503		

Caps



Cap					
Size (Inch)	Size (mm)	Spears PN	Reliable PN		
¾	20	4247-007	7167030000		
1	25	4247-010	7167040000		
1 ¼	32	4247-012	7167050000		
1 ½	40	4247-015	7167060000		
2	50	4247-020	7167080000		
2 ½	65	4247-025	7167100000		
3	76	4247-030	7167120000		

Sprinkler Tee 90°



Sprinkler Tee					
Size (Inch)	Size (mm)	Spears PN	Reliable PN		
¾ x ¾ x ½	20 x 20 x 15	4202-101	7119030302		
1 x 1 x ½	25 x 25 x 15	4202-130	7119040402		
1 x 1 x 1	25 x 25 x 25	4202-010	7119040404		
1 ¼ x 1 ¼ x ½	32 x 32 x 15	4202-166	7119050502		
1 ½ x 1 ½ x ½	40 x 40 x 15	4202-209	7119060602		
2 x 2 x ½	50 x 50 x 15	4202-247	7119080802		
1 ½ x 1 ¼ x ½	40 x 32 x 15	4202-199	7121060502		



Sprinkler Tee 90° - Socket x Reinforced Female Thread

Size (Inch)	Size (mm)	Spears PN	Reliable PN		
¾ x ¾ x ½	20 x 20 x 15	4202-101SR	7118030302		
1 x 1 x ½	25 x 25 x 15	4202-130SR	7118040402		



Sprinkler Tee 90° - Socket x Metal Female Thread

Size (Inch)	Size (mm)	Spears PN	Reliable PN		
1 x ½ x 1	25 x 15 x 25	4202-122	7119040204		

Sprinkler Elbow



Sprinkler Elbow - Sck Metal Female Thread					
Size (Inch)	Size (mm)	Spears PN	Reliable PN		
¾ x ½	20 x 15	4207-101	7109030201		
1 x ½	25 x 15	4207-130	7109040201		
1 x ¾	25 x 20	4207-131	7109040301		
1 ¼ x ½	32 x 15	4207-166	7109050201		



Sprinkler Elbow – Sck x Reinforced Female Plastic Thread					
Size (Inch)	Size (mm)	Spears PN	Reliable PN		
¾ x ½	20 x 15	4207-101SR	7109030200		



Sprinkler Elbow –EPDM Seal/Gasket Version (Torque Safe)					
Size (Inch)	Size (mm)	Spears PN	Reliable PN		
¾ x ½	20 x 15	4207-101GS	7109030205		
1 x ½	25 x 15	4207-130GS	7109040205		

Sprinkler Adaptor



Sprinkler Adaptor – Socket x Metal Female Thread					
Size (Inch)	Size (mm)	Spears PN	Reliable PN		
¾ x ½	20 x 15	4235-101	7135030201		
1 x ½	25 x 15	4235-130	7135040201		
1 x ¾	25 x 20	4235-131	7135040301		



Sprinkler Adaptor – Socket x Reinforced Female Thread					
Size (Inch)	Size (mm)	Spears PN	Reliable PN		
¾ x ½	20 x 15	Z4235-101SF	7135030202		



Sprinkler Adaptor – Metal EPDM Seal (TorqueSafe™)					
Size (Inch)	Size (mm)	Spears PN	Reliable PN		
¾" x ½"	20 x 15	4235-101GS	7135030205		
1" x ½"	25 x 15	4235-130GS	7135040205		



Sprinkler Adaptor – Spigot x Metal Female Thread					
Size (Inch)	Size (mm)	Spears PN	Reliable PN		
¾ SPG x ½	20 SPG x 15	4238-101	7139030201		
1 SPG x ½	25 SPG x 15	4238-130	7139040201		

Spigot Adaptor



Adaptor – Spigot x Metal Female Thread					
Size (Inch)	Size (mm)	Spears PN	RPN		
¾	20	4278-007	7139030300		
1	25	4278-010	7139040400		

Female Adaptor



Female Adaptor – Socket x Metal Female Thread (BSP)					
Size (Inch)	Size (mm)	Spears PN	Reliable PN		
1	25	4235-010BS	7U99001913		
1 ½	40	4235-015BS	7U99001914		
2	50	4235-020BS	7U99001915		



Female Adaptor – Socket x Metal Female Thread (NPT)					
Size (Inch)	Size (mm)	Spears PN	Reliable PN		
¾	20	4235-007	7158030000		
1	25	4235-010	7158040000		
1 ¼	32	4235-012	7158050000		
1 ½	40	4235-015	7158060000		
2	50	4235-020	7158080000		



Female Adaptor – Socket x Reinforced Female Thread (BSP)					
Size (Inch)	Size (mm)	Spears PN	Reliable PN		
1	25	4235-010SRBS	6990013046		
1 ¼	32	4235-012SRBS	7U99001971		

Male Adaptor



Male Adaptor – Socket x Metal Male Thread (BSP)					
Size (Inch)	Size (mm)	Spears PN	Reliable PN		
¾	20	4236-007	7157030000		
1	25	4236-010	7157040000		
1 ¼	32	4236-012	7157050000		
1 ½	40	4236-015	7157060000		
2	50	4236-020	7157080000		



Grooved Coupling Adaptor CPVC x Brass					
Size (Inch)	Size (mm)	Spears PN	Reliable PN		
1 ¼	32	4233-012	7149050501		
1 ½	40	4233-015	7149060601		
2	50	4233-020	7149080801		
2 ½	65	4233-025	7149101001		
3	76	4233-030	7149121201		



Test Plug

Test Plug					
Size (Inch)	Size (mm)	Spears PN	Reliable PN		
½	15	FTP-005	7139020000		



Cement

Cement (Glue)					
Size (Pint)	Size (ML)	Spears PN	Reliable PN		
One Step Pint	473 ML	FS5-020	7175000001		



Sealant

Sealant					
Size (Pint)	Size (ML)	Spears PN	Reliable PN		
Blue 75 Pint	473	SB75-020	7175000002		

Sealant					
Size (Quart)	Size (Ltrs)	Reliable PN			
Blue 75 Quart	0.95	7175050002			



Ball Valve

Ball Valve					
Size (Inch)	Size (mm)	Spears PN	Reliable PN		
¾	20	6622-007CO	6990005058		
1	25	6622-010CO	6990005059		