

MT-8 Threaded Mechanical Branch Tee

ANVILStar™
Fire Products Division of Anvil® International



Mechanical branch connections for reducing branch outlets without welding. The MT-8 is a bolted saddle type fitting with BSP female threaded outlets. Design assures superior sealing, full pipe support, excellent stability and easy installation.



APPROVED
For Listing/Approval Details
and Limitations visit our Web Site
www.anvilintl.com or contact an
Anvil®/AnvilStar™ Sales Representative.

MATERIAL SPECIFICATIONS

HOUSING:

Ductile Iron conforming to ASTM A-536, Grade 65-45-12.

ANSI BOLTS & HEAVY HEX NUTS:

Heat treated, oval neck track head bolts conforming to ASTM A-183 Grade 2 with a minimum tensile strength of 110,000 psi and heavy hex nuts of carbon steel conforming to ASTM A-563 Grade A or Grade B, or SAE J995 Grade 2. Bolts and nuts are provided zinc electroplated as standard.

STAINLESS STEEL BOLTS & NUTS:

Stainless steel bolts and nuts are also available. Contact an AnvilStar Representative for more information.

COATINGS:

Rust inhibiting paint Color: ORANGE (standard)
Hot Dipped Zinc Galvanized (optional)
Other available options: Example: RAL3000 or RAL9000 Series
For other coating requirements contact an AnvilStar Representative.

LUBRICATION:

Standard Gruvlok
Gruvlok Xtreme™ Required for dry pipe systems and freezer applications.

GASKETS: Materials

Properties as designated in accordance with ASTM D-2000

Grade "E" EPDM (Green color code)

-40°F to 230°F (Service Temperature Range)
(-40°C to 110°C) Recommended for water service, diluted acids, alkalis solutions, oil-free air and many chemical services.

NOT FOR USE IN PETROLEUM APPLICATIONS.

Grade "T" Nitrile (Orange color code)

-20°F to 180°F (Service Temperature Range)
(-29°C to 82°C) Recommended for petroleum applications. air with oil vapors and vegetable and mineral oils.

NOT FOR USE IN HOT WATER OR HOT AIR.

MT-8 Threaded Mechanical Branch Tee

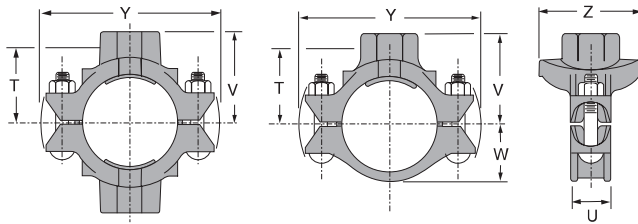

WARNING

For dry pipe systems and freezer applications lubrication of the gasket is required, Gruvlok® Xtreme™ Lubricant is Required.

MT-8 BSP THREADED MECHANICAL BRANCH TEE

Nominal Size	O.D.	Hole Dimension		Max. Wk. Pressure	Dimensions						Bolt Size	Approx. Wt. Ea.
		Min. Diameter	Max. Diameter		T	U	V	W	Y	Z		
ln./DN(mm)	ln./mm	ln./mm	ln./mm	PSI/bar	ln./mm	ln./mm	ln./mm	ln./mm	ln./mm	ln./mm	ln./mm	Lbs./kg
2 x 1	2.375 x 1.315	1½	1⅝	500	1½	1½	2⅝	1⅞	4⅝	2½	⅜ x 2	1.7
50 x 25	60.3 x 33.7	38	41	34.5	50	38	67	40	117	63		2.8
2 x 1¼	2.375 x 1.660	1¾	1⅞	500	1½	1½	2⅝	1⅞	4⅝	2½	⅜ x 2	1.7
50 x 32	60.3 x 42.4	44	48	34.5	49	38	67	40	117	63		0.8
2 x 1½	2.375 x 1.900	1¾	1⅞	500	1½	1½	2⅝	1⅞	4⅝	2⅞	⅜ x 2	1.7
50 x 40	60.3 x 48.3	44	48	34.5	49	38	67	40	117	73		0.8
3 O.D. x 1	2.996 x 1.315	1½	1⅝	500	2⅞	2	3⅞	1⅞	5⅞	3⅞	½ x 2¾	3.6
76.1 x 25	76.1 x 33.7	38	41	34.5	62	51	81	48	145	86		1.6
3 O.D. x 1¼	2.996 x 1.660	2	2⅞	500	2⅞	2	3⅞	1⅞	5⅞	3⅞	½ x 2¾	3.6
76.1 x 32	76.1 x 42.4	51	54	34.5	62	51	81	48	145	86		1.6
3 O.D. x 1½	2.996 x 1.900	2	2⅞	500	2⅞	2	3⅞	1⅞	5⅞	3⅞	½ x 2¾	3.6
76.1 x 40	76.1 x 48.3	51	54	34.5	62	51	81	48	145	86		1.6
3 x 1	3.500 x 1.315	1½	1⅝	500	2¾	2	3⅞	2⅞	6¼	3⅞	½ x 2¾	3.8
80 x 25	88.9 x 33.7	38	41	34.5	71	51	87	55	159	99		1.7
3 x 1¼	3.500 x 1.660	2	2⅞	500	2¾	2	3⅞	2⅞	6¼	3⅞	½ x 2¾	3.8
80 x 32	88.9 x 42.4	51	54	34.5	70	51	87	55	159	99		1.7
3 x 1½	3.500 x 1.900	2	2⅞	500	2¾	2	3⅞	2⅞	6¼	3⅞	½ x 2¾	3.8
80 x 40	88.9 x 48.3	51	54	34.5	70	51	87	55	159	99		1.7
3 x 2	3.500 x 2.375	2½	2⅝	500	2¾	2	3⅞	2⅞	6¼	3⅞	½ x 2¾	4.4
80 x 50	88.9 x 60.3	64	67	34.5	70	51	87	55	159	99		2.0
4 x 1	4.500 x 1.315	1½	1⅝	500	3⅞	2	4	2⅞	7¼	3⅞	½ x 2¾	4.6
100 x 25	114.3 x 33.7	38	41	34.5	85	51	102	67	184	97		2.1
4 x 1¼	4.500 x 1.660	2	2⅞	500	3⅞	2	4	2⅞	7¼	3⅞	½ x 2¾	4.6
100 x 32	114.3 x 42.4	51	54	34.5	84	51	102	67	184	97		2.1
4 x 1½	4.500 x 1.900	2	2⅞	500	3⅞	2	4	2⅞	7¼	3⅞	½ x 2¾	4.6
100 x 40	114.3 x 48.3	51	54	34.5	84	51	102	67	184	97		2.1
4 x 2	4.500 x 2.375	2½	2⅝	500	3⅞	2	4	2⅞	7¼	4½	½ x 2¾	4.8
100 x 50	114.3 x 60.3	64	67	34.5	84	51	102	67	184	115		2.2
4 x 3 O.D.	4.500 x 2.996	2¾	2⅞	500	3⅞	2	4	2⅞	7¼	4½	½ x 2¾	5.4
100 x 76.1	114.3 x 76.1	70	73	34.5	78	51	102	67	184	115		2.4
6 x 1½	6.625 x 1.900	2	2⅞	500	4⅞	2¼	5⅞	3⅞	9⅞	3⅞	⅝ x 4	8.0
150 x 40	168.3 x 48.3	51	54	34.5	113	57	130	94	238	98		3.6
6 x 2	6.625 x 2.375	2½	2⅝	500	4⅞	2¼	5⅞	3⅞	9⅞	4⅞	⅝ x 4	8.0
150 x 50	168.3 x 60.3	64	67	34.5	112	57	130	94	238	112		3.6
6 x 3 O.D.	6.625 x 2.996	2¾	2⅞	500	4⅞	2¼	5⅞	3⅞	9⅞	4⅞	⅝ x 4	8.0
150 x 76.1	168.3 x 76.1	70	73	34.5	106	57	130	94	238	112		3.6
6½ O.D. x 1½	6.500 x 1.900	2	2⅞	500	4⅞	2¼	5⅞	3⅞	9¼	3⅞	⅝ x 4	9.4
165.1 x 40	165.1 x 48.3	51	54	34.5	110	57	129	93	235	98		4.3
6½ O.D. x 2	6.500 x 2.375	2½	2⅝	500	4⅞	2¼	5⅞	3⅞	9¼	4⅞	⅝ x 4	12.6
165.1 x 50	165.1 x 60.3	64	67	34.5	110	57	129	93	235	112		5.7
6½ O.D. x 3 O.D.	6.500 x 2.996	2¾	2⅞	500	4⅞	2¼	5⅞	3⅞	9¼	4⅞	⅝ x 4	10.3
165.1 x 76.1	165.1 x 76.1	70	73	34.5	106	57	130	93	235	112		4.7

All sizes may be used as mechanical crosses.
Threads are British Standard Parallel (BSP) per BS-21.