

C-4 Rigid Coupling

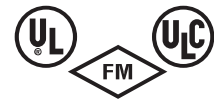

The C-4 rigid coupling is our standard coupling and is designed for rigid piping applications. The C-4 is specially designed to provide a rigid, locked-in pipe connection to meet the specific demands of rigid design steel pipe.



APPROVED

For Listing/Approval Details and Limitations visit our Web Site www.anvilintl.com or contact an Anvil®/AnvilStar™ Sales Representative.

MATERIAL SPECIFICATIONS

HOUSING:

Ductile Iron conforming to ASTM A-536, Grade 65-45-12.

ANSI BOLTS & HEAVY HEX NUTS:

Heat treated, oval neck track head bolts conforming to ASTM A-183 Grade 2 with a minimum tensile strength of 110,000 psi and heavy hex nuts of carbon steel conforming to ASTM A-563 Grade A or Grade B, or SAE J995 Grade 2. Bolts and nuts are provided zinc electroplated as standard.

METRIC BOLTS & HEAVY HEX NUTS:

Heat treated, zinc electroplated oval-neck track head bolts made of carbon steel with mechanical properties per ISO 898-1 Class 8.8. Hex nuts and bolts are zinc electroplated followed by a yellow chromate dip.

STAINLESS STEEL BOLTS & NUTS:

Stainless steel bolts and nuts are also available. Contact an AnvilStar Representative for more information.

COATINGS:

Rust inhibiting paint Color: ORANGE (standard)
Hot Dipped Zinc Galvanized (optional)
Other available options: Example: RAL3000 or RAL9000 Series
For other coating requirements contact an AnvilStar Representative.

LUBRICATION:

Standard Gruvlok
Gruvlok Xtreme™ Required for dry pipe systems and freezer applications.

GASKETS: Materials

Properties as designated in accordance with ASTM D-2000.

Grade "E" EPDM (Green color code) NSF-61 Certified

-40°F to 230°F (Service Temperature Range)(-40°C to 110°C)

Recommended for water service, diluted acids, alkalis solutions, oil-free air and many chemical services.

NOT FOR USE IN PETROLEUM APPLICATIONS.

Pre-Lubricated "C" Style Grade "E" Gasket (Violet color code)

-40°F to 150°F (Service Temperature Range)(-40°C to 65°C)

Recommended for wet and dry (oil free air) pipe fire protection sprinkler systems. For dry pipe systems and freezer applications, Gruvlok Xtreme™ Lubricant is required.

Grade "T" Nitrile (Orange color code)

-20°F to 180°F (Service Temperature Range)(-29°C to 82°C)

Recommended for petroleum applications, air with oil vapors and vegetable and mineral oils.

NOT FOR USE IN HOT WATER OR HOT AIR.

GASKET TYPE:

Standard C Style
Flush Gap (1 1/4" - 8")

C-4 Rigid Coupling

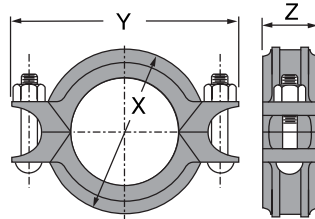

C-4 RIGID COUPLING

Nominal Size	O.D.	Max. Wk. Pressure	Max. End Load	Range of Pipe End Separation	Coupling Dimensions			Coupling Bolts		Specified Torque §		Approx. Wt. Ea.
					X	Y	Z	Qty.	Size	Min.	Max.	
In./DN(mm)	In./mm	PSI/bar	Lbs. (kN)	In./mm	In./mm	In./mm	In./mm		In./mm	Ft.-Lbs./N-m	Lbs./kg	
1¼ 32	1.660 42.2	300 20.7	649 2.89	0-0.06 0-1.5	2¾ 70	4⅝ 117	1⅞ 48	2	¾ x 2	30 40	45 60	1.5 0.7
1½ 40	1.900 48.3	300 20.7	851 3.78	0-0.06 0-1.5	2⅜ 71	4⅞ 124	1⅞ 48	2	¾ x 2	30 40	45 60	1.7 0.8
2 50	2.375 60.3	300 20.7	1,329 5.91	0-0.06 0-1.5	3½ 89	5⅜ 137	2 51	2	¾ x 2¼	30 40	45 60	1.9 0.9
2½ 65	2.875 73.0	300 20.7	1,948 8.66	0-0.06 0-1.5	4 102	6 152	2 51	2	¾ x 2½	30 40	45 60	1.9 0.8
3 O.D. 76.1	2.996 76.1	300 20.7	2,115 9.41	0-0.06 0-1.5	4⅞ 105	6⅞ 156	1⅞ 48	2	¾ x 2½	30 40	45 60	2.2 1.0
3 80	3.500 88.9	300 20.7	2,886 12.84	0-0.12 0-3.2	4¾ 121	6⅝ 168	2 51	2	¾ x 2½	30 40	45 60	2.4 1.1
4 100	4.500 114.3	300 20.7	4,771 21.22	0-0.12 0-3.2	5⅞ 149	7¾ 197	2⅞ 54	2	¾ x 2½	30 40	45 60	3.2 1.4
5 125	5.563 141.3	300 20.7	7,292 32.44	0-0.12 0-3.2	6⅝ 176	9⅞ 230	2⅞ 52	2	½ x 3	80 110	100 150	4.5 2.0
6½ O.D. 165.1	6.500 165.1	300 20.7	9,955 44.28	0-0.12 0-3.2	8⅞ 207	10⅝ 264	2⅞ 54	2	½ x 3	80 110	100 150	5.8 2.6
6 150	6.625 168.3	300 20.7	10,341 46.00	0-0.12 0-3.2	8¼ 210	10⅝ 264	2⅞ 54	2	½ x 3	80 110	100 150	5.8 2.6
8 200	8.625 219.1	300 20.7	17,528 77.97	0-0.12 0-3.2	10½ 267	13¼ 337	2½ 64	2	⅝ x 3½	100 130	130 175	10.8 4.9
10 250	10.750 273.1	300 20.7	27,229 121.12	0-0.12 0-3.2	13 331	16¾ 425	2⅝ 67	2	⅞ x 5	180 245	220 298	21.5 9.8
12 300	12.750 323.9	300 20.7	38,303 170.38	0-0.12 0-3.2	15⅝ 391	19¼ 489	2⅝ 67	2	⅞ x 5½	180 245	220 298	27.4 12.4

1. Working pressure and/or end load are total allowable, based on standard weight steel pipe, roll or cut grooved.

2. One time field test pressure may be increased to 1.5 times the figures listed above.

§ - For additional Bolt Torque information see Technical Data Section.

Other sizes available, contact an AnvilStar Representative.



WARNING
For dry pipe systems and freezer applications
lubrication of the gasket is required, Gruvlok®
Xtreme™ Lubricant is Required.